

HUNTER CREEK HOMES INC.

THE ABBEY

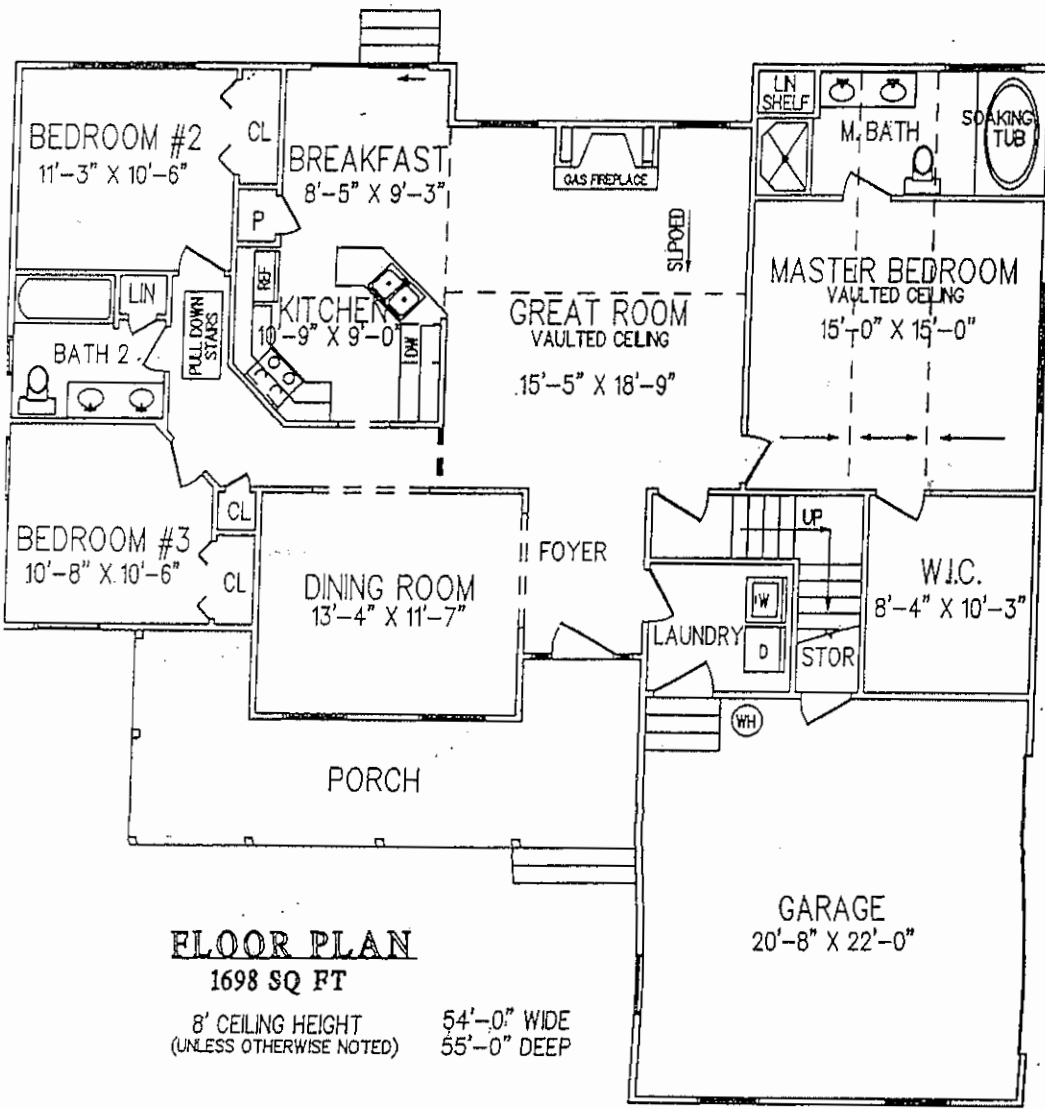

- 3 BEDROOMS
- 2 BATHS
- COVERED FRONT PORCH
- VAULTED GREAT ROOM
- 2 CAR GARAGE
- OPTIONAL BONUS ROOM

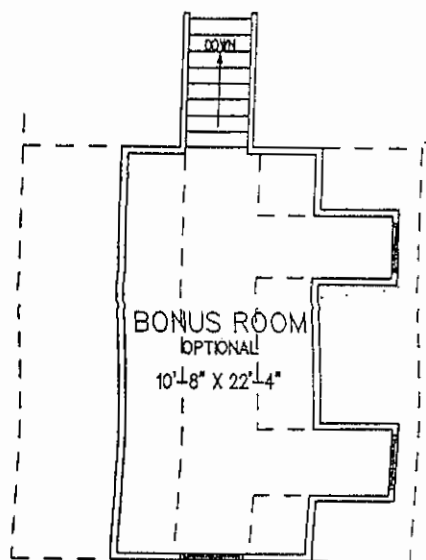

FLOOR PLAN
1698 SQ FT

8' CEILING HEIGHT
(UNLESS OTHERWISE NOTED) 54'-0" WIDE
55'-0" DEEP